

Stream Restoration

STERLING, MASSACHUSETTS

The planting plan and plant schedule Ecotropy provided was part of a team effort lead by Rushing Rivers Institute, with funding from Central Massachusetts Trout Unlimited and Nestlé Waters. After the removal of a series of dams and channels obstructing a small stream in Central Massachusetts to help foster fish habitat, volunteers from Fitchburg State University helped to install the Native plants. The planting reflects appropriate facultative qualities of the plant communities, provides habitat value for birds, fish and small mammals and provides social value for the community with a beautiful place to go and learn about their local ecological communities.



CONCEPTUAL SECTION ILLUSTRATING STREAM BED AND RHIZOSPHERE CONDITIONS BEFORE RESTORATION



CONCEPTUAL SECTION ILLUSTRATING STREAM BED AND RHIZOSPHERE CONDITIONS AFTER RESTORATION

Planting Plan -

Central MA Trout Unlimited Project # 146

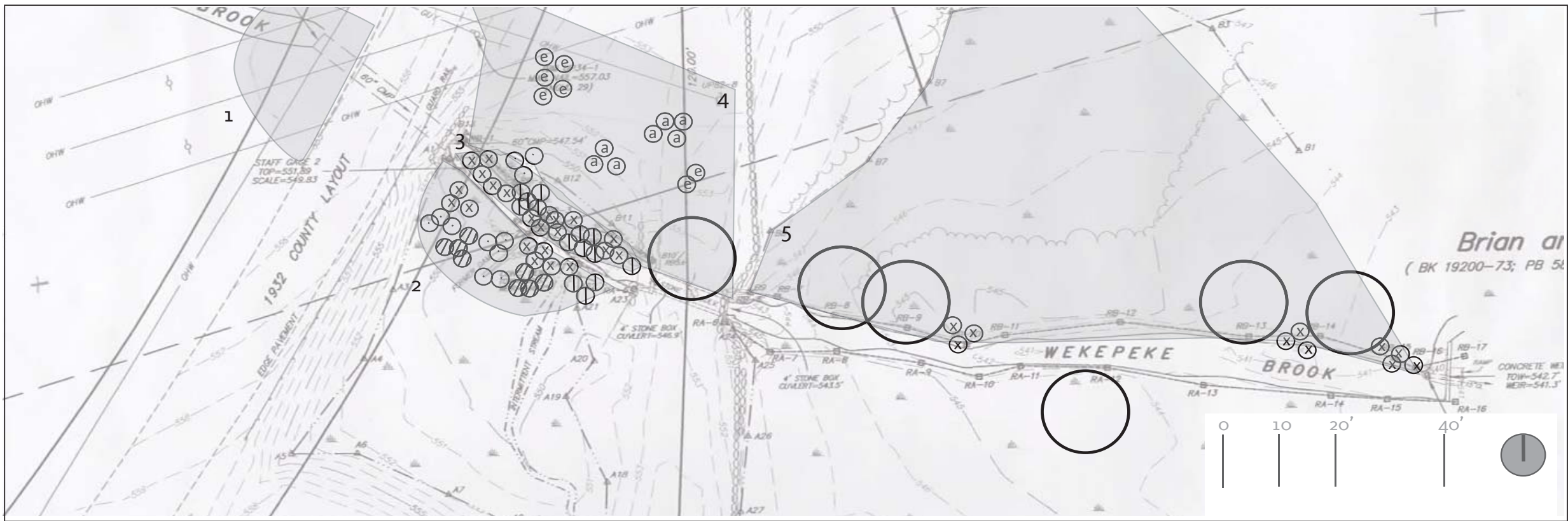



Featured Plants

 Elderberry

 Spicebush

 Sycamore

 Buttonbush

 Black Chokecherry

 Pepperbush

Zone 1 -
Roadside Culvert replacement
1 lb Detention Basin seed mix - @400 sq. ft

Zone 2 -
Forested Wetland
Clethera Alnifolia (pepper bush) - 11
Lindera Benzoin (spice bush) - 8

Zone 3 -
Stream Bank
Salix (Willow) - 32
Cephalanthus (Button Bush) - 14
1 lb wetland seed mix

Zone 4 -
Upland Remediation
2 lbs Detention Basin Mix
Aronia Melanocarpa (black chokecherry) - 7
Sambucus Canadensis (elderberry) - 7

Zone 5 -
Invasive removal & some restoration
Platanus occidentalis (Sycamore) - 6

Stream Restoration

STERLING, MASSACHUSETTS



